

## REPLACEMENT CARTRIDGE

Remove lid from pitcher. Dislodge used cartridge from reservoir by pushing cartridge upward through holding space. After following steps 1-3 below, place new cartridge in, pressing firmly to ensure a tight seal. Reset electronic fill indicator as instructed.

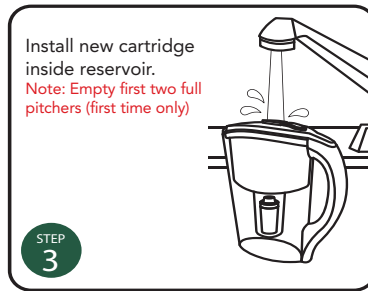
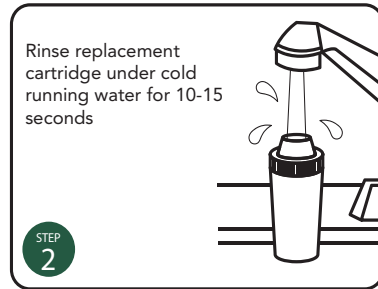

## Need Help?

Our support team is here to make sure you are completely satisfied with your product.

## Contact Us?

[support@natureshavenshop.com](mailto:support@natureshavenshop.com)

## ® Water Pitcher Filter System INSTALLATION AND OPERATION GUIDE

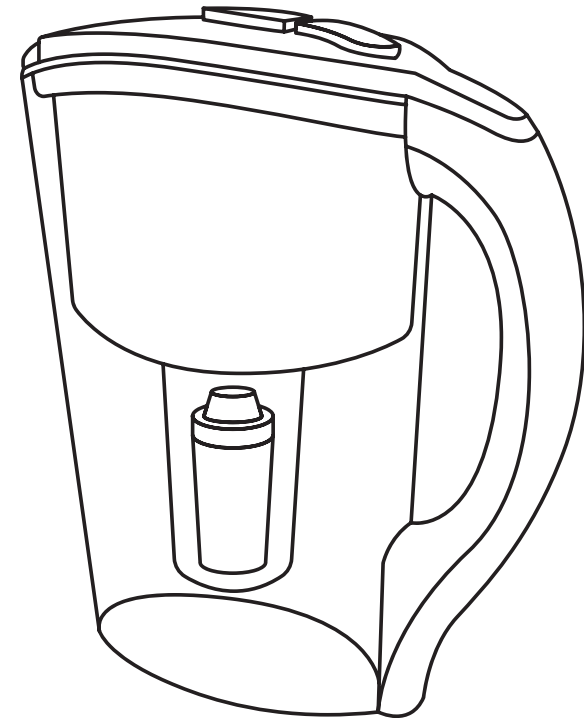

## CARE AND OPTIMUM USE

1. Use cold water only. Do not use water above 85°F/ 29°C. This may damage the filter cartridge (2).
2. Hand wash lid (1), reservoir (3), and pitcher (4) with mild, soapy water.
3. The contaminants or other substances removed or reduced by this water filter are not necessarily in all users' water.
4. Do not use with water that is microbiologically unsafe or of unknown quality.

Your Pitcher Water Filter\* system contains a cartridge that must be replaced at regular intervals to maintain proper performance.

- The filter cartridge has a limited service life\*. Use only Nature's Haven® approved cartridges.
- Changes in taste, odor, and flow of the water being filtered indicate that cartridge should be replaced.
- Do not use non-Nature's Haven® parts or modify/ tamper with unit.
- **DO NOT** run hot water through unit.
- **DO NOT** use where water is microbiologically unsafe.

### OPERATING SPECIFICATIONS

Temperature Range: 40-85° (4.4-29° C)

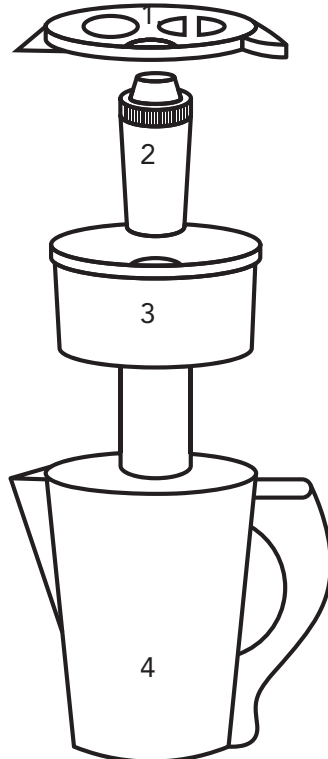

Fig. 1

\*Capacity: Approximately 2,000 gallons (6-12 months). Life of the cartridge varies with water consumption and water condition

## TROUBLESHOOTING

1. **Unfiltered water leaks into the filtered water reservoir:** Check to be sure that the filter cartridge (2) has been pushed firmly into place.
2. **Dust appears in the filter water reservoir:** Filter cartridge (2, Fig 1) is not flushed properly. Flush new cartridges.
3. **Water not filtering through cartridge:** It is recommended that you clean replacement cartridge to avoid clogging. In certain geographical areas the cartridge may need to be cleaned more often.
4. For more information refer to labels and website.

## INSTALLATION INSTRUCTIONS

Unpack pitcher and filter cartridge from plastic wrapping and follow steps below.

Soak filter upright in cold water for 20 minutes (first time only).

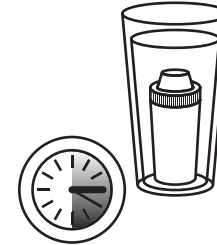

STEP 1

Hand-wash pitcher, lid, and reservoir with mild detergent.

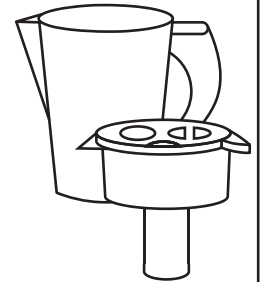

STEP 2

Rinse pitcher filter cartridge under cold water for 10-15 seconds.



STEP 3

Fit reservoir inside pitcher until first ridge is flush with pitcher rim.

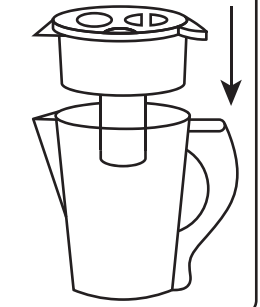

STEP 4

Insert pitcher filter cartridge into reservoir. Press firmly to ensure a tight seal.



STEP 5

Fill reservoir with tap water, allowing water to flow into bottom part of pitcher, and you will have fresh, clean water in seconds.  
**Note: Empty first two full pitchers (first time only)**

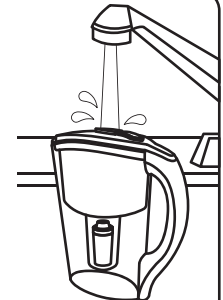

STEP 6